

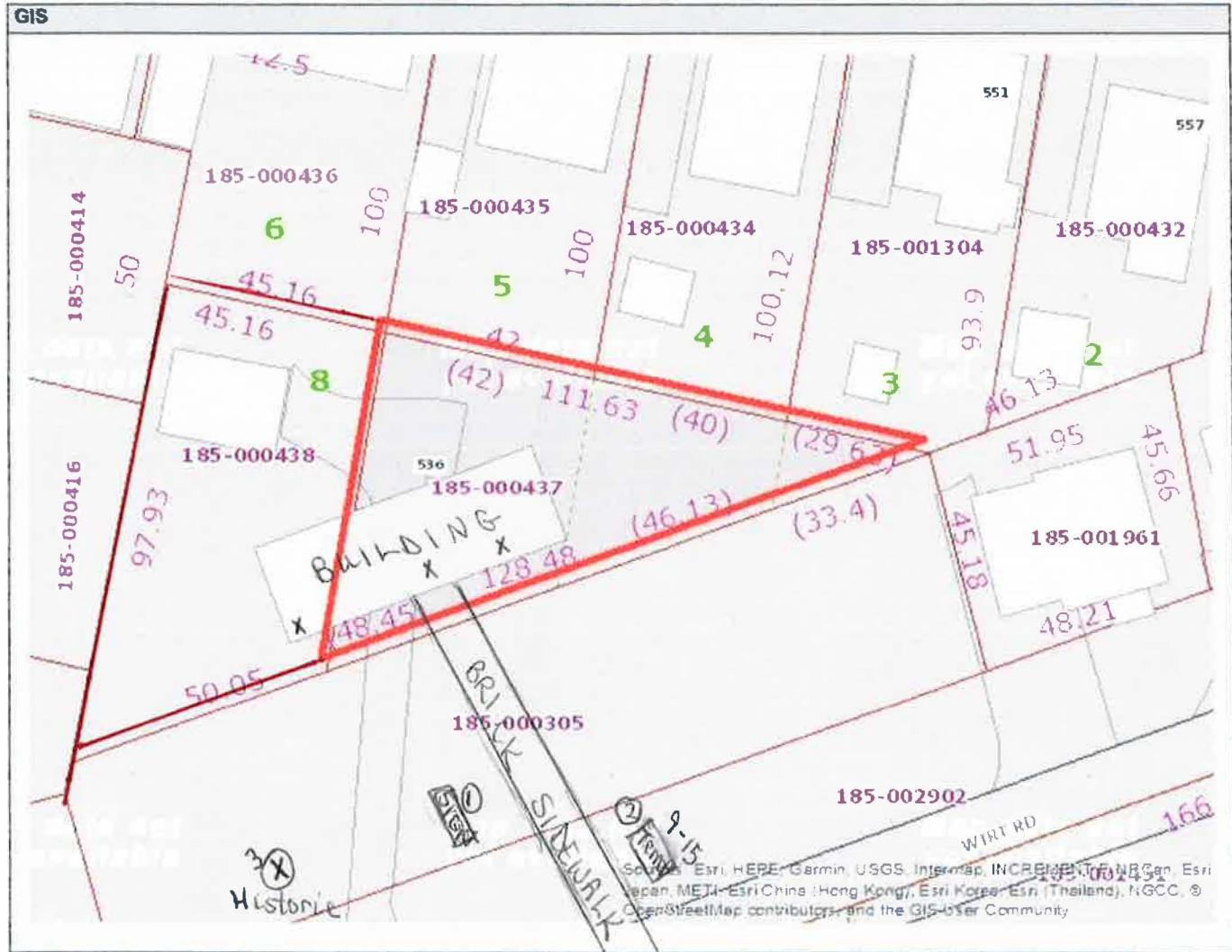

## MAP(GIS)

Generated on 09/04/2018 at 06:04:54 PM

Parcel ID	Map Routing No	Owner	Location
18500043700	185N004 03400	GROVEPORT HERITAGE AND PRESERVATION SOCI	536 WIRT RD



### Disclaimer

This drawing is prepared for the real property inventory within this county. It is compiled from recorded deeds, survey plats, and other public records and data. Users of this drawing are notified that the public primary information source should be consulted for verification of the information contained on this drawing. The county and the mapping companies assume no legal responsibilities for the information contained on this drawing. Please notify the Franklin County GIS Division of any discrepancies.

The information on this web site is prepared for the real property inventory within this county. Users of this data are notified that the public primary information source should be consulted for verification of the information contained on this site. The county and vendors assume no legal responsibilities for the information contained on this site. Please notify the Franklin County Auditor's Real Estate Division of any discrepancies.





7

X

6



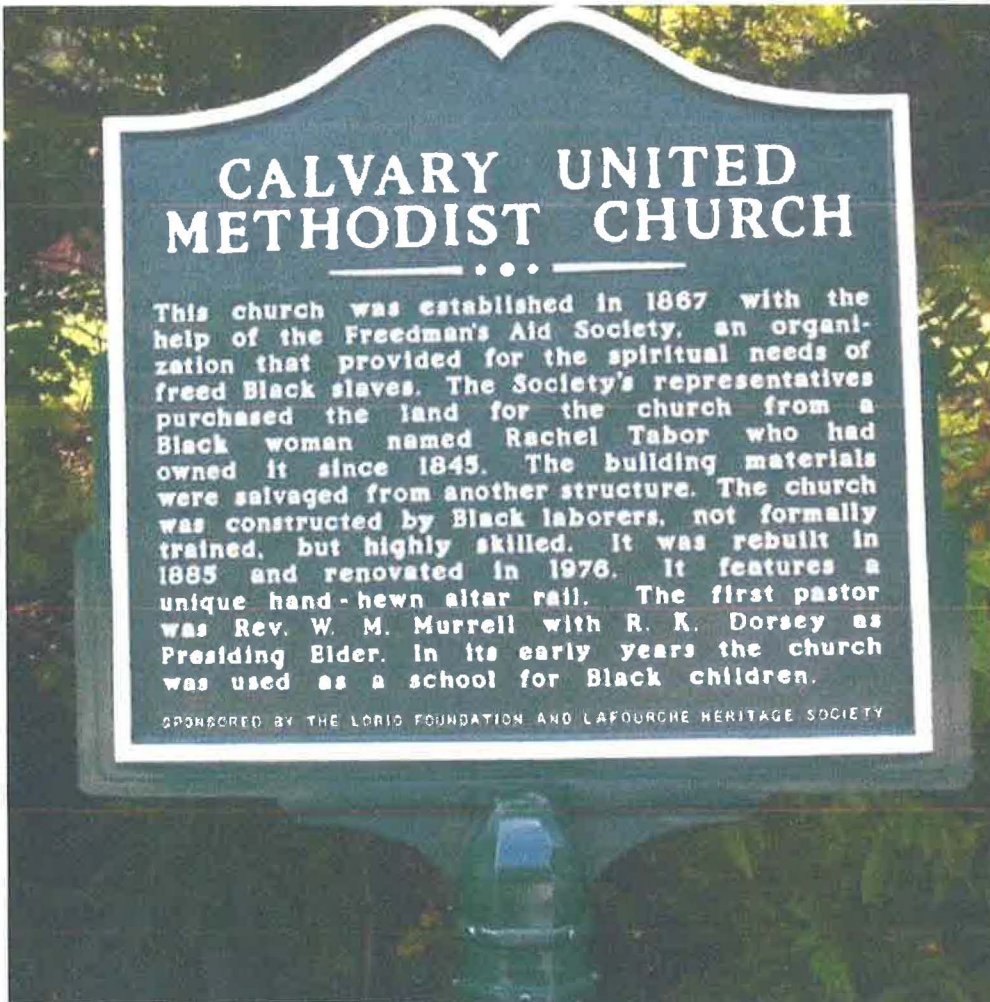

③  
Historic  
Marker  
(brown/gold letters)  
possible

4 ft. above  
grade

### SHARP'S LANDING OHIO & ERIE CANAL BUILDING

This building, dating back to the mid-1800's, sat along the Ohio & Erie Canal in the settlement known as Sharp's Landing, approximately one mile south of here. It once served multiple purposes for the community and those passing by on the canal route. The east portion was an icehouse, the center section was where the meat was processed, and the west end contained the bakery. In 2015, the building was salvaged by the Groveport Heritage and Preservation Society and relocated to this site in order to maintain its location along the canal line. It represents the significance of the canal, along with other forms of transportation, to the Groveport area.



SIGNS HUNG ON BUILDING

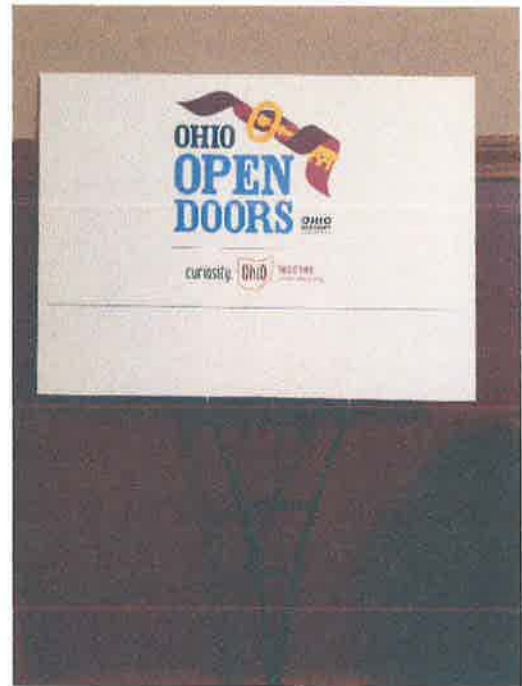

#2 TEMPORARY SIGN FOR SEPT. 15 EVENT



#1 Sharp's Landing sign